

# Cottam Solar Project

## Public Rights of Way Plan Revision E

Prepared by: Lanpro Services  
February 2024

PINS reference: EN010133  
Document reference: EX5/C2.5\_E  
APFP Regulation 5(2)(k)



## Schedule of Changes

| Figure Reference | Page      | Description of Changes  | Reason for Revision  |
|------------------|-----------|---|--|
| Sheet 19         | 22        | Point 19iv/a moved west to the end of the BOAT to be temporarily stopped up line                    | Resulting from amendments to Public Right of Way Schedules in the final version of the draft DCO and to ensure changes as a result of the change application are fully captured. |
| Sheet 19         | 22        | Point 119iv/b moved east to the end of the BOAT to be temporarily stopped up line                   | Resulting from amendments to Public Right of Way Schedules in the final version of the draft DCO and to ensure changes as a result of the change application are fully captured. |
| Sheet 19 and 20  | 22 and 23 | Inclusion of a new potential temporary PRow diversion area to north and south of Torksey Ferry Road | Resulting from amendments to Public Right of Way Schedules in the final version of the draft DCO and to ensure changes as a result of the change application are fully captured. |

All other changes made to text and to tables are shown as tracked changes.

- Key**
- Order Limits
  - Sheet Index
  - DMMO route
  - DMMO route to be temporarily stopped up
  - Potential DMMO Diversion Area
  - Potential PROW Diversion Area
  - PROW**
  - Bridleway
  - Restricted Byway
  - Byway Open to All Traffic
  - PROW to be temporarily stopped up**
  - Bridleway
  - Footpath
  - Restricted Byway
  - Byway Open to All Traffic

Layers: Lincolnshire County Council, 2024; Nottinghamshire County Council, 2024; North Lincolnshire County Council, 2024; Lanpro, 2024; IGD, 2024  
 Base map: Reproduced from Ordnance Survey digital map data © Crown copyright 2024. All rights reserved. License number 0100031673

0 1 2 3 Kilometres  
 Scale: 1:25,000@A0

|                                |                            |
|--------------------------------|----------------------------|
| APFP Regulation: 5(2)(k)       | Application Doc No. C2.5_E |
| Ref: P2981_LPR_ZZ_ON_DR_Z_0089 | Date: 30/01/2024           |
| Drawn by: AZ                   | Checked by: BR             |

**Public Rights of Way Plan**  
 Index Sheet  
 Revision E

---

**COTTAM SOLAR PROJECT**

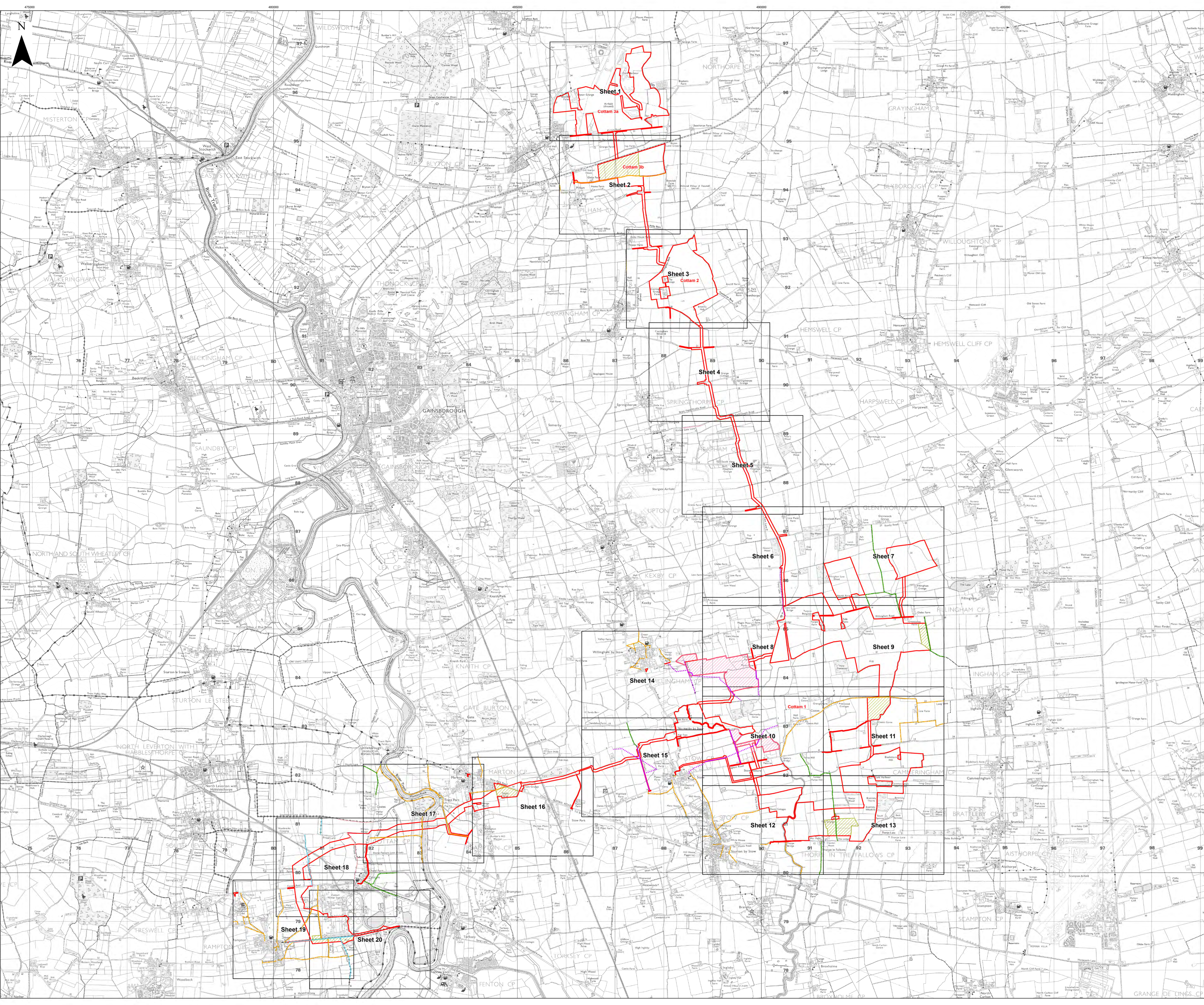

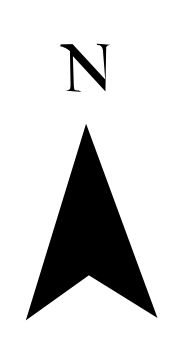

**Key**

- Order Limits
- Sheet Index

Note:  
The Definitive Map Modification Order (DMMO) routes shown on the plan are not public rights of way but indicate routes where DMMO applications have been made for these routes to be recorded as public rights of way.  
The temporary stopping up of the DMMO route is subject to approval and will only be considered once accepted within the rights of way definitive map.

Layers: Lincolnshire County Council, 2024; Nottinghamshire County Council, 2024; North Lincolnshire County Council, 2024; Lanpro, 2024; IGP, 2024  
Base map: Reproduced from Ordnance Survey digital map data © Crown copyright 2024. All rights reserved. License number 0100031673

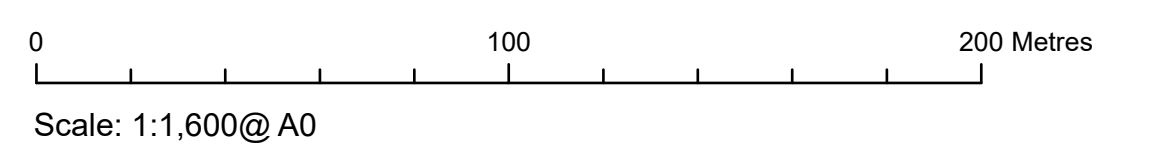

|                                |                            |
|--------------------------------|----------------------------|
| APFP Regulation: 5(2)(k)       | Application Doc No. C2.5_E |
| Ref: P2961_LPR_ZZ_ON_DR_Z_0089 | Date: 27/02/2024           |
| Drawn by: AZ                   | Checked by: BR             |

**Public Rights of Way Plan**  
Sheet 1 of 20  
Revision E

**COTTAM SOLAR PROJECT**

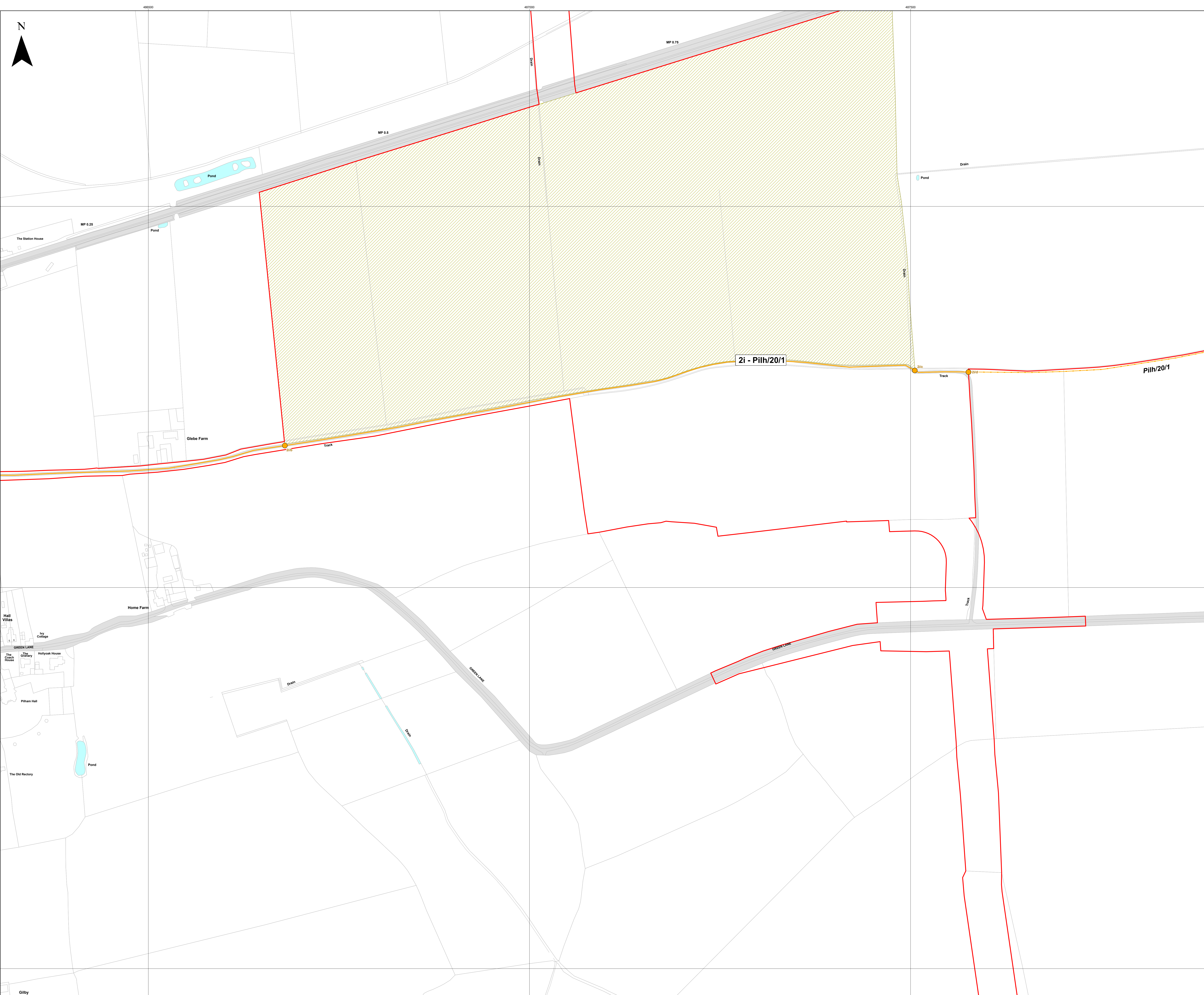

**Key**

- Order Limits
- Sheet Index
- Potential PRoW Diversion Area
- PRoW
- Footpath
- PRoW to be temporarily stopped up
- Footpath
- PRoW to be temporarily stopped up - start and end points
- Footpath

Note:  
The Definitive Map Modification Order (DMMO) routes shown on the plan are not public rights of way but indicate routes where DMMO applications have been made for these routes to be recorded as public rights of way.  
The temporary stopping up of the DMMO route is subject to approval and will only be considered once accepted within the rights of way definitive map.

Layers: Lincolnshire County Council, 2024; Nottinghamshire County Council, 2024; North Lincolnshire County Council, 2024; Lanpro, 2024; IGP, 2024  
Base map: Reproduced from Ordnance Survey digital map data © Crown copyright 2024. All rights reserved. License number 0100031673

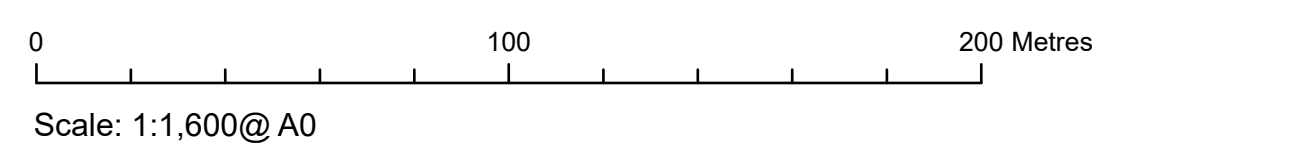

|                                |                            |
|--------------------------------|----------------------------|
| APFP Regulation: 5(2)(k)       | Application Doc No. C2.5_E |
| Ref: P2961_LPR_ZZ_ON_DR_Z_0089 | Date: 27/02/2024           |
| Drawn by: AZ                   | Checked by: BR             |

**Public Rights of Way Plan**  
Sheet 2 of 20  
Revision E

**COTTAM SOLAR PROJECT**

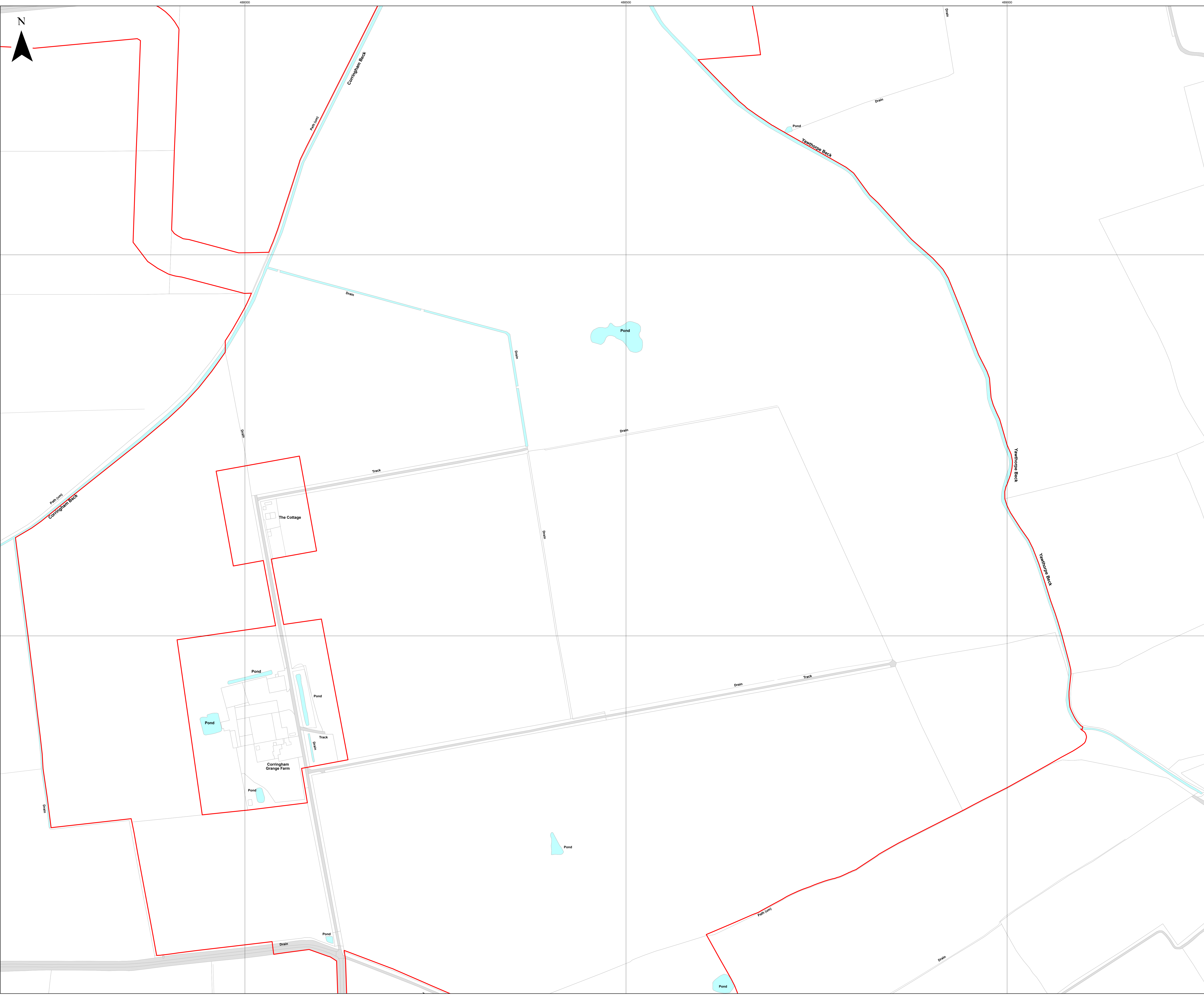

**Key**

- Order Limits
- Sheet Index

Note:  
The Definitive Map Modification Order (DMMO) routes shown on the plan are not public rights of way but indicate routes where DMMO applications have been made for these routes to be recorded as public rights of way.  
The temporary stopping up of the DMMO route is subject to approval and will only be considered once accepted within the rights of way definitive map.

Layers: Lincolnshire County Council, 2024; Nottinghamshire County Council, 2024; North Lincolnshire County Council, 2024; Lanpro, 2024; IGP, 2024  
Base map: reproduced from Ordnance Survey digital map data © Crown copyright 2024. All rights reserved. License number 0100031673

0 100 200 Metres  
Scale: 1:1,600@ A0

|                                |                            |
|--------------------------------|----------------------------|
| APFP Regulation: 5(2)(k)       | Application Doc No. C2.5_E |
| Ref: P2961_LPR_ZZ_ON_DR_Z_0089 | Date: 27/02/2024           |
| Drawn by: AZ                   | Checked by: BR             |

**Public Rights of Way Plan**  
Sheet 3 of 20  
Revision E

**COTTAM SOLAR PROJECT**

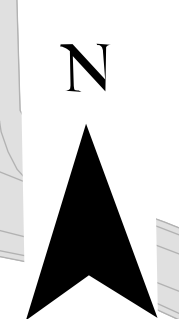
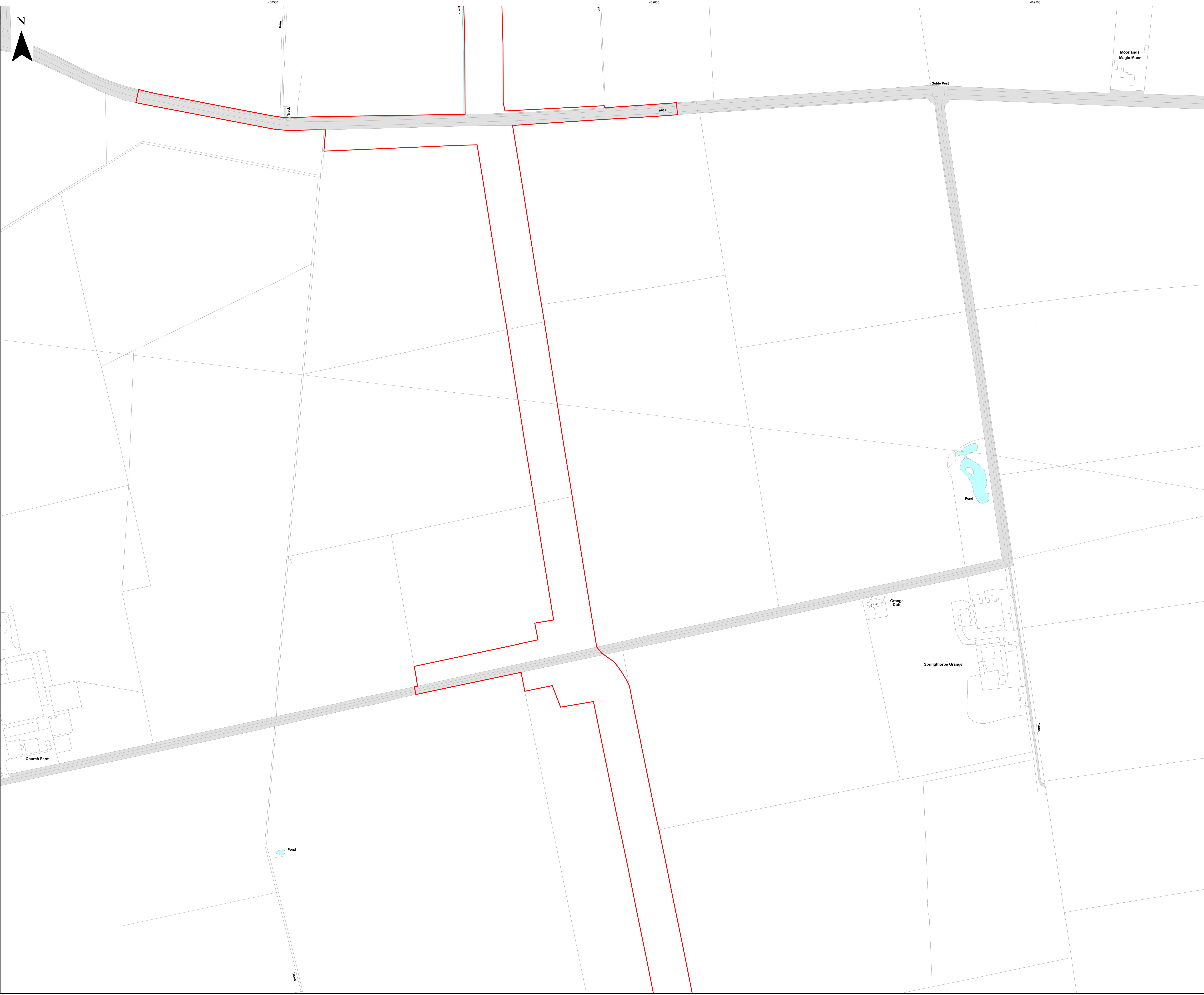

**Key**

- Order Limits
- Sheet Index

Note:  
The Definitive Map Modification Order (DMMO) routes shown on the plan are not public rights of way but indicate routes where DMMO applications have been made for these routes to be recorded as public rights of way.  
The temporary stopping up of the DMMO route is subject to approval and will only be considered once accepted within the rights of way definitive map.

Layers: Lincolnshire County Council, 2024; Nottinghamshire County Council, 2024; North Lincolnshire County Council, 2024; Lanpro, 2024; IGP, 2024  
Base map: Reproduced from Ordnance Survey digital map data © Crown copyright 2024. All rights reserved. License number 0100031673

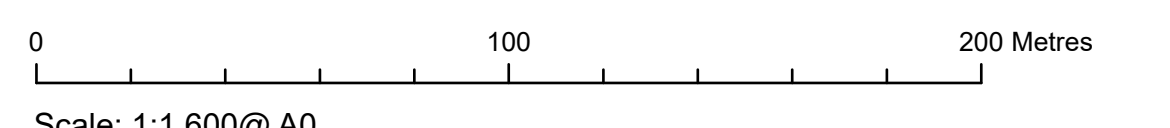

Scale: 1:1,600@ A0

|                                |                            |
|--------------------------------|----------------------------|
| APFP Regulation: 5(2)(k)       | Application Doc No. C2.5_E |
| Ref: P2961_LPR_ZZ_ON_DR_Z_0089 | Date: 27/02/2024           |
| Drawn by: AZ                   | Checked by: BR             |

**Public Rights of Way Plan**  
Sheet 4 of 20  
Revision E

**COTTAM SOLAR PROJECT**

**Key**

- Order Limits
- Sheet Index

Note:  
The Definitive Map Modification Order (DMMO) routes shown on the plan are not public rights of way but indicate routes where DMMO applications have been made for these routes to be recorded as public rights of way.  
The temporary stopping up of the DMMO route is subject to approval and will only be considered once accepted within the rights of way definitive map.

Layers: Lincolnshire County Council, 2024; Nottinghamshire County Council, 2024; North Lincolnshire County Council, 2024; Lanpro, 2024; IGP, 2024  
Base map: Reproduced from Ordnance Survey digital map data © Crown copyright 2024. All rights reserved. License number 0100031673

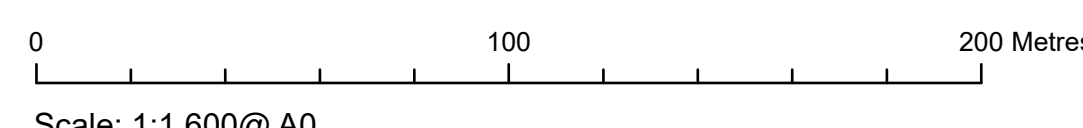

Scale: 1:1,600@A0

|                                |                            |
|--------------------------------|----------------------------|
| APFP Regulation: 5(2)(k)       | Application Doc No. C2.5_E |
| Ref: P2961_LPR_ZZ_ON_DR_Z_0089 | Date: 27/02/2024           |
| Drawn by: AZ                   | Checked by: BR             |

**Public Rights of Way Plan**  
Sheet 5 of 20  
Revision E

**COTTAM SOLAR PROJECT**







**Key**

- Order Limits
- Sheet Index
- DMMO route

Note:  
The Definitive Map Modification Order (DMMO) routes shown on the plan are not public rights of way but indicate routes where DMMO applications have been made for these routes to be recorded as public rights of way.  
The temporary stopping up of the DMMO route is subject to approval and will only be considered once accepted within the rights of way definitive map.

Layers: Lincolnshire County Council, 2024; Nottinghamshire County Council, 2024; North Lincolnshire County Council, 2024; Lanpro, 2024; IGP, 2024  
Base map: Reproduced from Ordnance Survey digital map data © Crown copyright 2024. All rights reserved. License number 0100031673

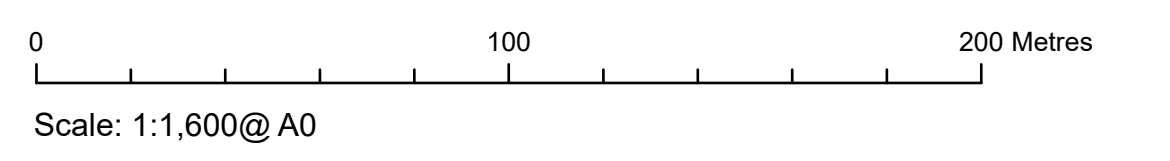

|                                |                            |
|--------------------------------|----------------------------|
| APFP Regulation: 5(2)(k)       | Application Doc No. C2.5_E |
| Ref: P2961_LPR_ZZ_ON_DR_Z_0089 | Date: 27/02/2024           |
| Drawn by: AZ                   | Checked by: BR             |

**Public Rights of Way Plan**  
Sheet 6 of 20  
Revision E

**COTTAM SOLAR PROJECT**

**Key**

- Order Limits
- Sheet Index
- PRow
- Bridleway

Note:  
The Definitive Map Modification Order (DMMO) routes shown on the plan are not public rights of way but indicate routes where DMMO applications have been made for these routes to be recorded as public rights of way.  
The temporary stopping up of the DMMO route is subject to approval and will only be considered once accepted within the rights of way definitive map.

Layers: Lincolnshire County Council, 2024; Nottinghamshire County Council, 2024; North Lincolnshire County Council, 2024; Lanpro, 2024; IGP, 2024  
Base map: Reproduced from Ordnance Survey digital map data © Crown copyright 2024. All rights reserved. License number 0100031673

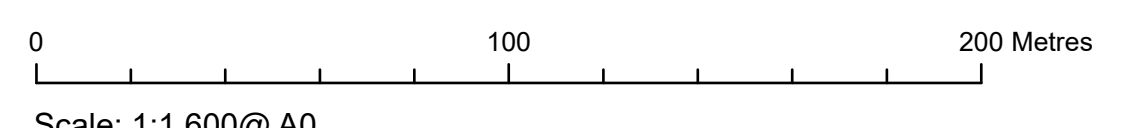

Scale: 1:1,600@A0

|                                |                            |
|--------------------------------|----------------------------|
| AAPP Regulation: 5(2)(k)       | Application Doc No. C2.5_E |
| Ref: P2961_LPR_ZZ_ON_DR_Z_0089 | Date: 27/02/2024           |
| Drawn by: AZ                   | Checked by: BR             |

**Public Rights of Way Plan**  
Sheet 7 of 20  
Revision E

**COTTAM SOLAR PROJECT**

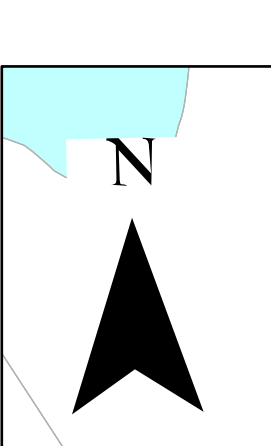

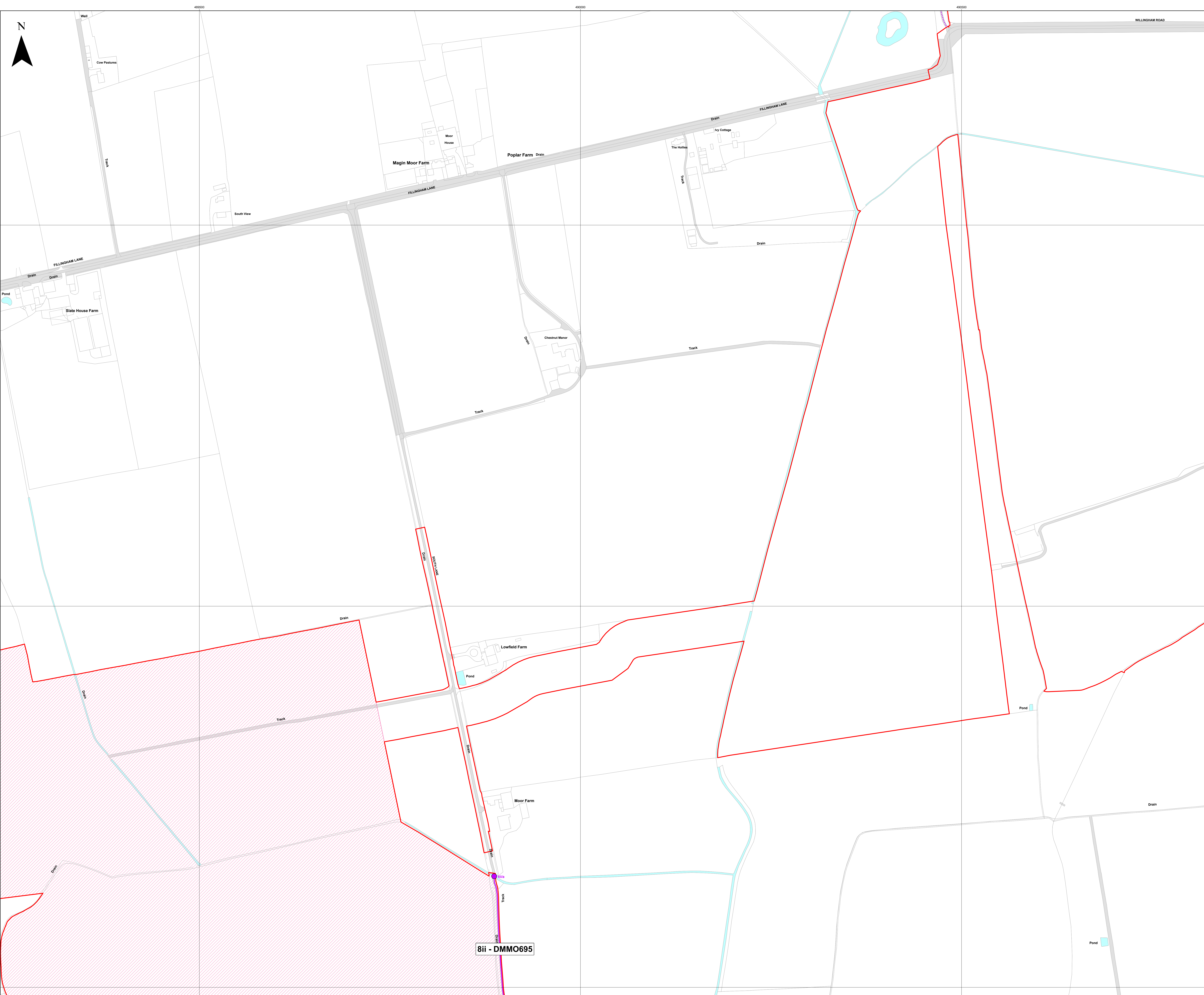

- Key**
- Order Limits
  - Sheet Index
  - Potential DMMO Diversion Area
  - DMMO route
  - DMMO route to be temporarily stopped up
  - DMMO to be temporarily stopped up - start and end points

Note:  
The Definitive Map Modification Order (DMMO) routes shown on the plan are not public rights of way but indicate routes where DMMO applications have been made for these routes to be recorded as public rights of way.  
The temporary stopping up of the DMMO route is subject to approval and will only be considered once accepted within the rights of way definitive map.

Layers: Lincolnshire County Council, 2024; Nottinghamshire County Council, 2024; North Lincolnshire County Council, 2024; Lanpro, 2024; IGP, 2024  
Base map: Reproduced from Ordnance Survey digital map data © Crown copyright 2024. All rights reserved. License number 0100031673

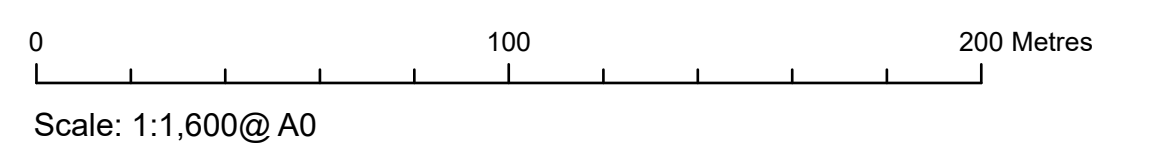

|                                |                            |
|--------------------------------|----------------------------|
| APFP Regulation: 5(2)(k)       | Application Doc No. C2.5_E |
| Ref: P2961_LPR_ZZ_ON_DR_Z_0089 | Date: 27/02/2024           |
| Drawn by: AZ                   | Checked by: BR             |

**Public Rights of Way Plan**  
Sheet 8 of 20  
Revision E

**COTTAM SOLAR PROJECT**

**8ii - DMMO695**

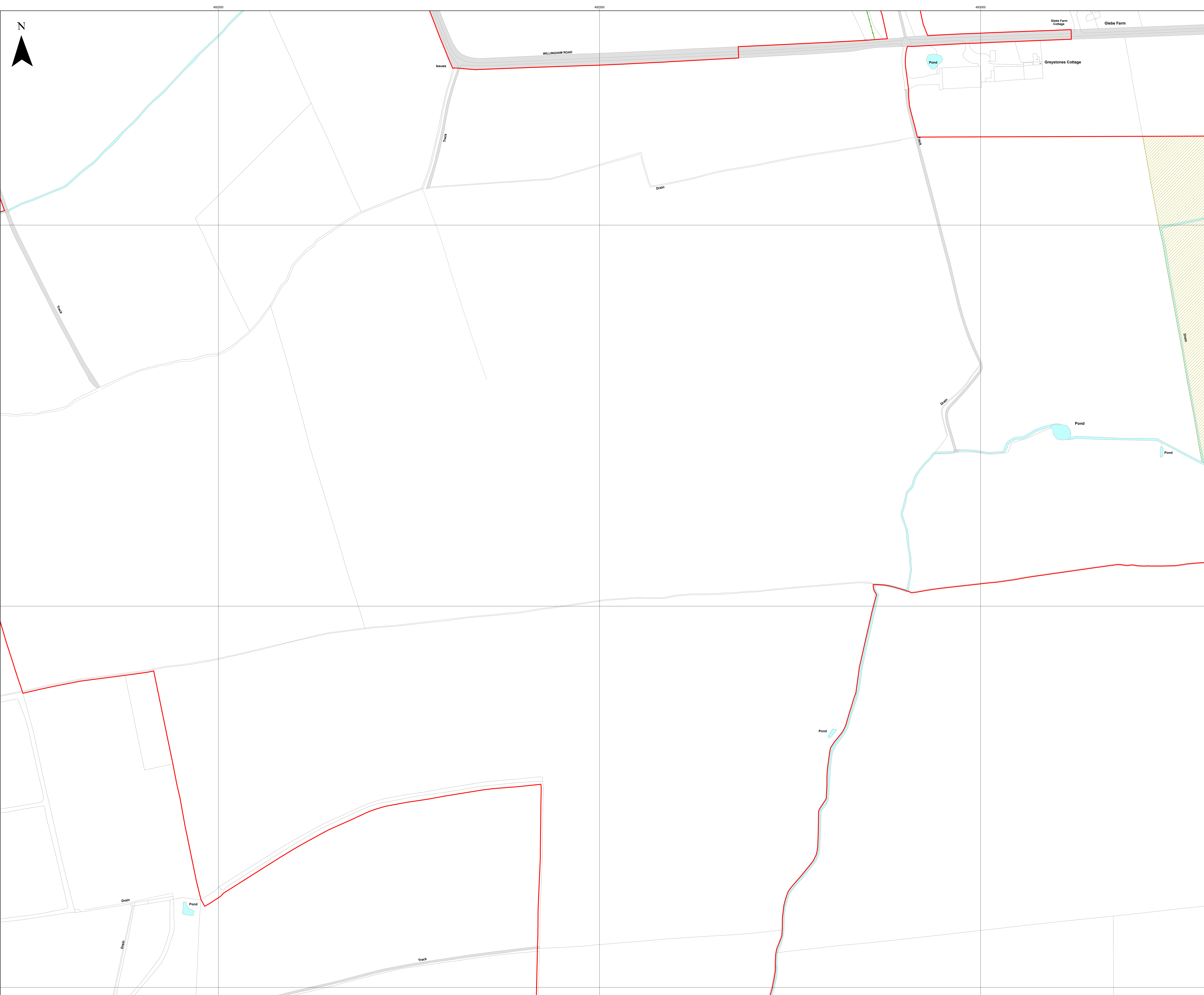

**Key**

- Order Limits
- Sheet Index
- Potential PRow Diversion Area
- PRow
- Bridleway

**Note:**  
The Definitive Map Modification Order (DMMO) routes shown on the plan are not public rights of way but indicate routes where DMMO applications have been made for these routes to be recorded as public rights of way.  
The temporary stopping up of the DMMO route is subject to approval and will only be considered once accepted within the rights of way definitive map.

Layers: Lincolnshire County Council, 2024; Nottinghamshire County Council, 2024; North Lincolnshire County Council, 2024; Lanpro, 2024; IGP, 2024  
Base map: Reproduced from Ordnance Survey digital map data © Crown copyright 2024. All rights reserved. License number 0100031673

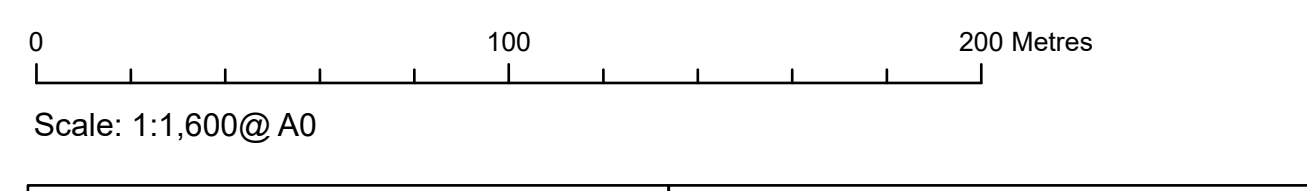

|                                |                            |
|--------------------------------|----------------------------|
| APFP Regulation: 5(2)(k)       | Application Doc No. C2.5_E |
| Ref: P2961_LPR_ZZ_ON_DR_Z_0089 | Date: 27/02/2024           |
| Drawn by: AZ                   | Checked by: BR             |

**Public Rights of Way Plan**  
Sheet 9 of 20  
Revision E

**COTTAM SOLAR PROJECT**

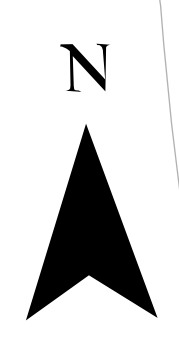
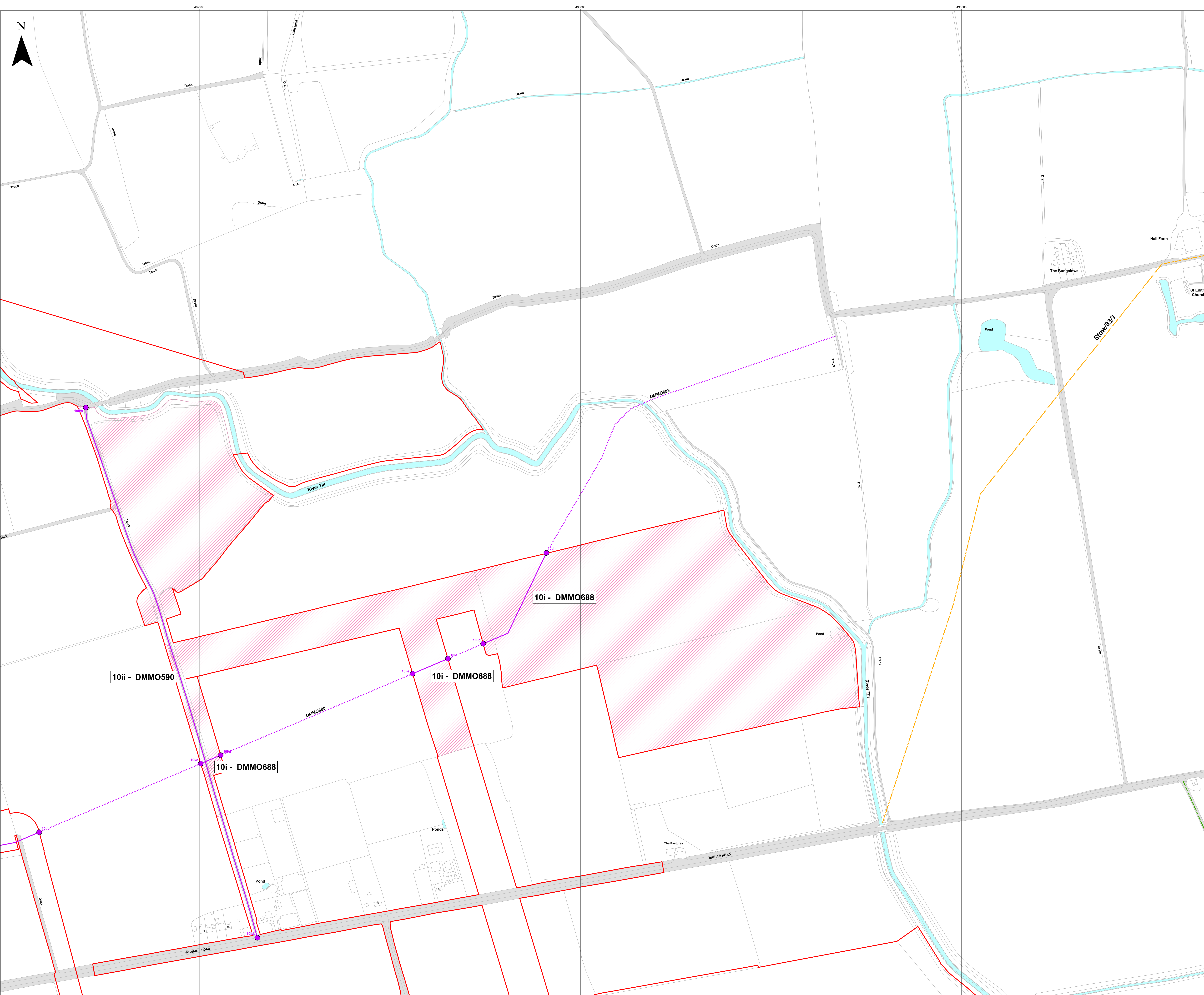

- Key**
- Order Limits
  - Sheet Index
  - Potential DMMO Diversion Area
  - DMMO route
  - DMMO route to be temporarily stopped up
  - DMMO to be temporarily stopped up - start and end points
- PRoW**
- Bridleway
  - Footpath

Note:  
The Definitive Map Modification Order (DMMO) routes shown on the plan are not public rights of way but indicate routes where DMMO applications have been made for these routes to be recorded as public rights of way.  
The temporary stopping up of the DMMO route is subject to approval and will only be considered once accepted within the rights of way definitive map.

Layers: Lincolnshire County Council, 2024; Nottinghamshire County Council, 2024; North Lincolnshire County Council, 2024; Lanpro, 2024; IGP, 2024  
Base map: Reproduced from Ordnance Survey digital map data © Crown copyright 2024. All rights reserved. License number 0100031673

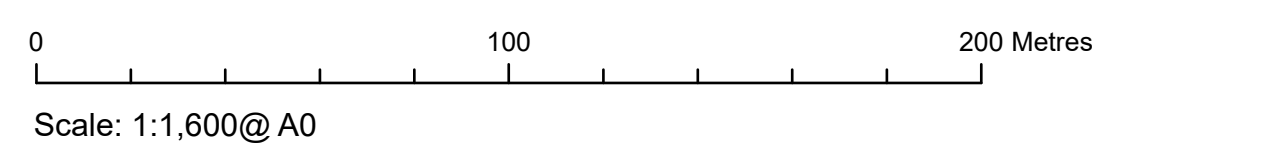

|                                |                            |
|--------------------------------|----------------------------|
| APFP Regulation: 5(2)(k)       | Application Doc No. C2.5_E |
| Ref: P2961_LPR_ZZ_ON_DR_Z_0089 | Date: 27/02/2024           |
| Drawn by: AZ                   | Checked by: BR             |

**Public Rights of Way Plan**  
Sheet 10 of 20  
Revision E

**COTTAM SOLAR PROJECT**

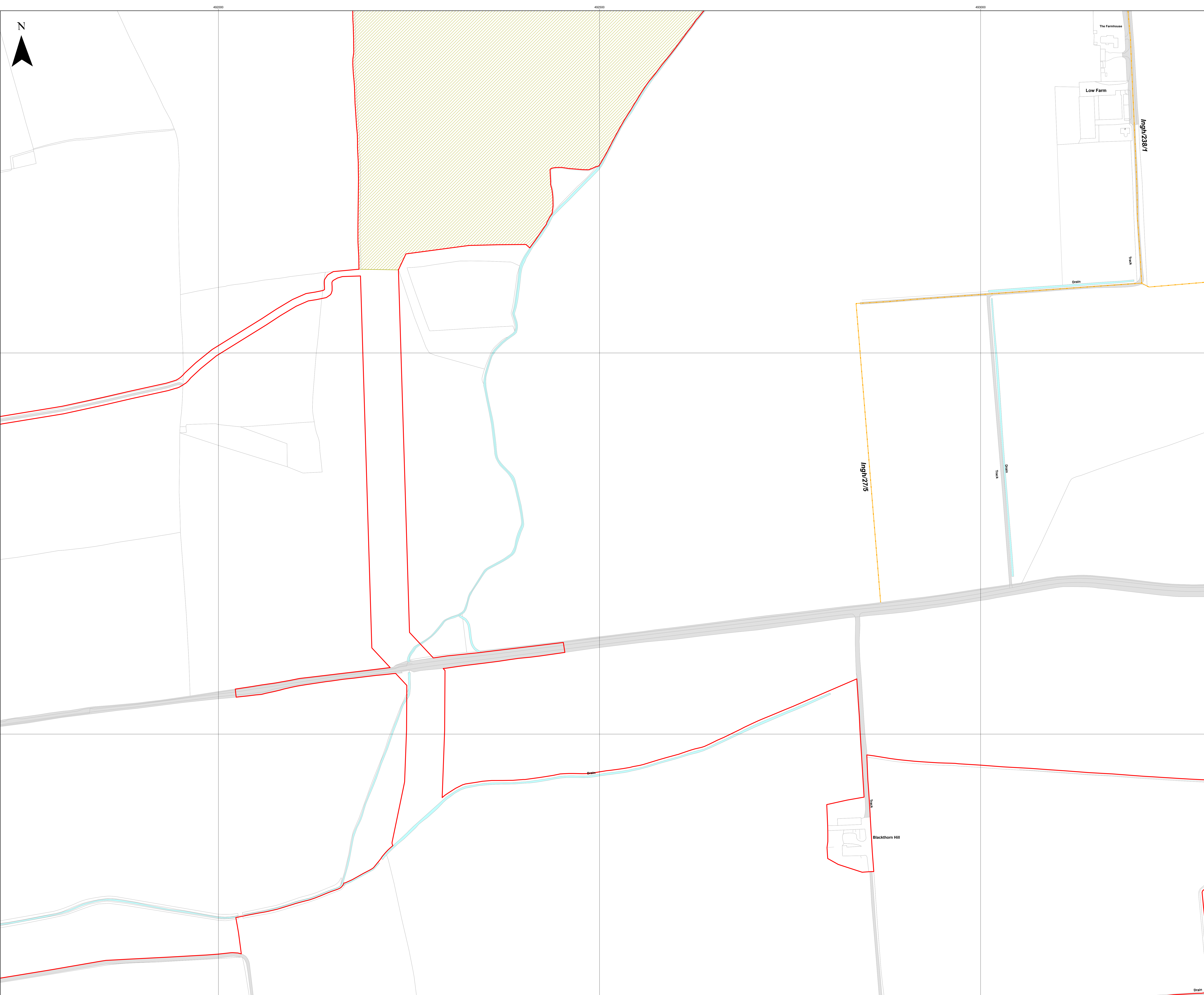

- Key**
- Order Limits
  - Sheet Index
  - Potential PRow Diversion Area
  - PRow
  - Footpath

**Note:**  
 The Definitive Map Modification Order (DMMO) routes shown on the plan are not public rights of way but indicate routes where DMMO applications have been made for these routes to be recorded as public rights of way.  
 The temporary stopping up of the DMMO route is subject to approval and will only be considered once accepted within the rights of way definitive map.

Layers: Lincolnshire County Council, 2024; Nottinghamshire County Council, 2024; North Lincolnshire County Council, 2024; Lanpro, 2024; IGP, 2024  
 Base map: Reproduced from Ordnance Survey digital map data © Crown copyright 2024. All rights reserved. License number 0100031673

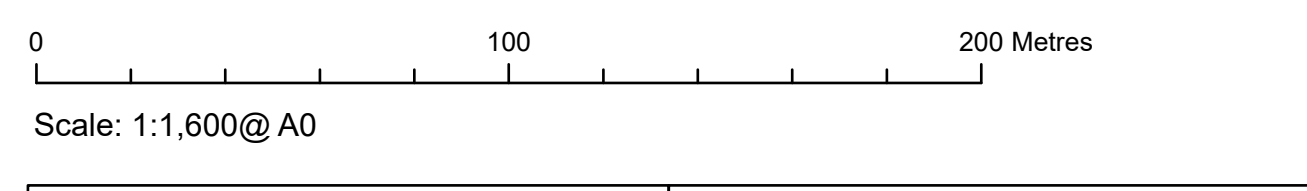

|                                |                            |
|--------------------------------|----------------------------|
| APFP Regulation: 5(2)(k)       | Application Doc No. C2.5_E |
| Ref: P2961_LPR_ZZ_ON_DR_Z_0089 | Date: 27/02/2024           |
| Drawn by: AZ                   | Checked by: BR             |

**Public Rights of Way Plan**  
 Sheet 11 of 20  
 Revision E

**COTTAM SOLAR PROJECT**

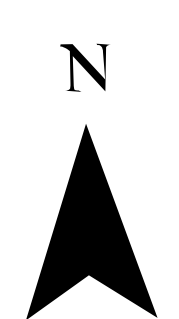

**Key**

- Order Limits
- Sheet Index
- P Prow
- P Footpath

Note:  
The Definitive Map Modification Order (DMMO) routes shown on the plan are not public rights of way but indicate routes where DMMO applications have been made for these routes to be recorded as public rights of way.  
The temporary stopping up of the DMMO route is subject to approval and will only be considered once accepted within the rights of way definitive map.

Layers: Lincolnshire County Council, 2024; Nottinghamshire County Council, 2024; North Lincolnshire County Council, 2024; Lanpro, 2024; IGP, 2024  
Base map: reproduced from Ordnance Survey digital map data © Crown copyright 2024. All rights reserved. License number 0100031673

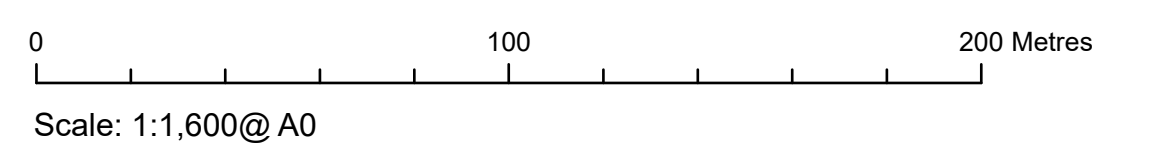

|                                |                            |
|--------------------------------|----------------------------|
| APFP Regulation: 5(2)(k)       | Application Doc No. C2.5_E |
| Ref: P2961_LPR_ZZ_ON_DR_Z_0089 | Date: 27/02/2024           |
| Drawn by: AZ                   | Checked by: BR             |

**Public Rights of Way Plan**  
Sheet 12 of 20  
Revision E

**COTTAM SOLAR PROJECT**

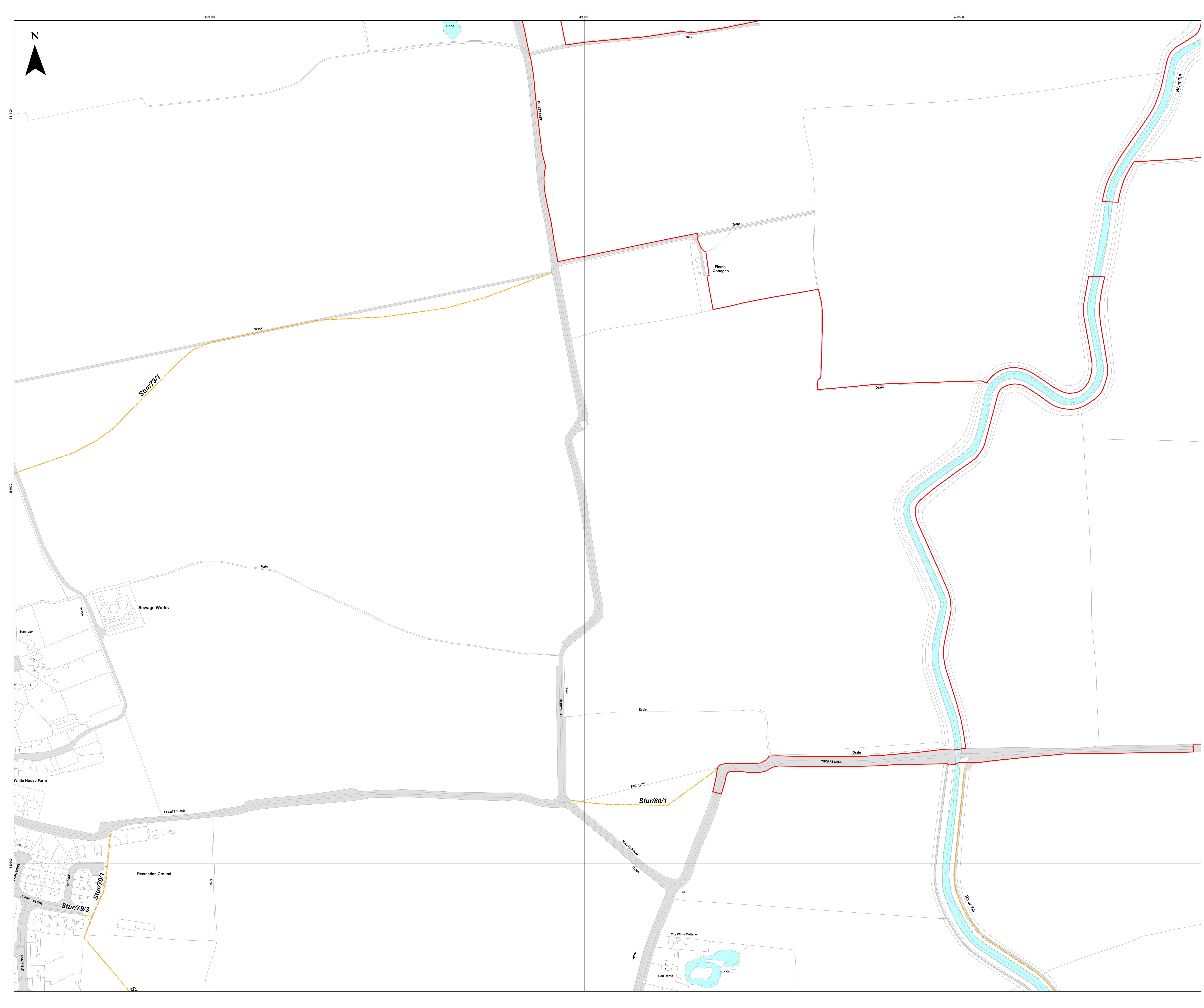

**Key**

- Order Limits
- Sheet Index
- Potential PRow Diversion Area

Note:  
The Definitive Map Modification Order (DMMO) routes shown on the plan are not public rights of way but indicate routes where DMMO applications have been made for these routes to be recorded as public rights of way.  
The temporary stopping up of the DMMO route is subject to approval and will only be considered once accepted within the rights of way definitive map.

Layers: Lincolnshire County Council, 2024; Nottinghamshire County Council, 2024; North Lincolnshire County Council, 2024; Lanpro, 2024; IGP, 2024  
Base map: Reproduced from Ordnance Survey digital map data © Crown copyright 2024. All rights reserved. License number 0100031673

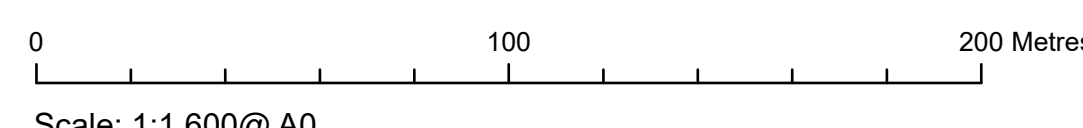

Scale: 1:1,600@ A0

|                                |                            |
|--------------------------------|----------------------------|
| APFP Regulation: 5(2)(k)       | Application Doc No. C2.5_E |
| Ref: P2961_LPR_ZZ_ON_DR_Z_0089 | Date: 27/02/2024           |
| Drawn by: AZ                   | Checked by: BR             |

**Public Rights of Way Plan**  
Sheet 13 of 20  
Revision E

**COTTAM SOLAR PROJECT**

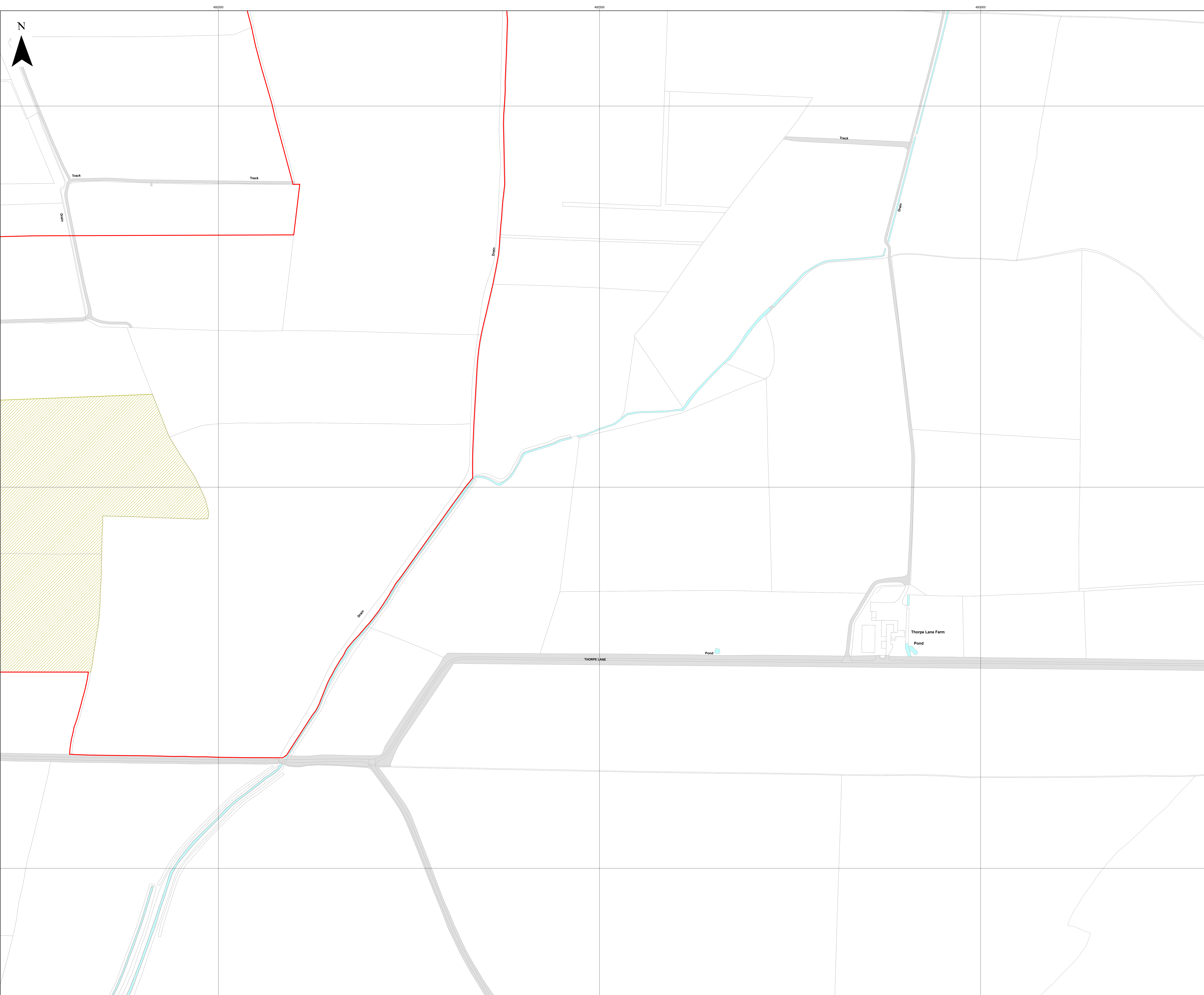





- Key**
- Order Limits
  - Sheet Index
  - Potential DMMO Diversion Area
  - DMMO route
  - PROW**
  - Footpath

**Note:**  
 The Definitive Map Modification Order (DMMO) routes shown on the plan are not public rights of way but indicate routes where DMMO applications have been made for these routes to be recorded as public rights of way.  
 The temporary stopping up of the DMMO route is subject to approval and will only be considered once accepted within the rights of way definitive map.

Layers: Lincolnshire County Council, 2024; Nottinghamshire County Council, 2024; North Lincolnshire County Council, 2024; Lanpro, 2024; IGP, 2024  
 Base map: Reproduced from Ordnance Survey digital map data © Crown copyright 2024. All rights reserved. License number 0100031673

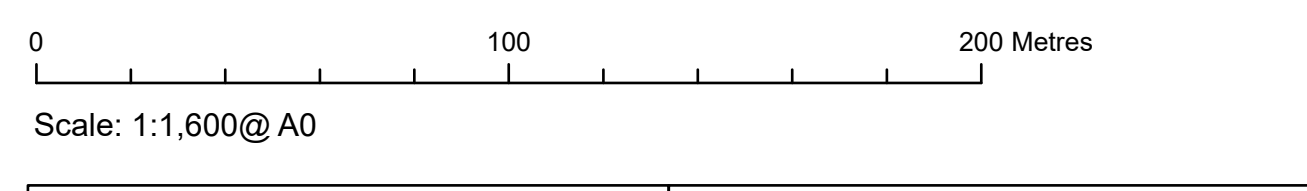

|                                |                            |
|--------------------------------|----------------------------|
| APFP Regulation: 5(2)(k)       | Application Doc No. C2.5_E |
| Ref: P2961_LPR_ZZ_ON_DR_Z_0089 | Date: 27/02/2024           |
| Drawn by: AZ                   | Checked by: BR             |

**Public Rights of Way Plan**  
 Sheet 14 of 20  
 Revision E

**COTTAM SOLAR PROJECT**

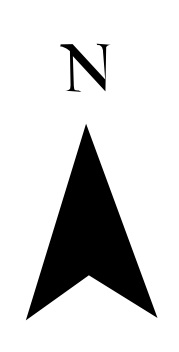
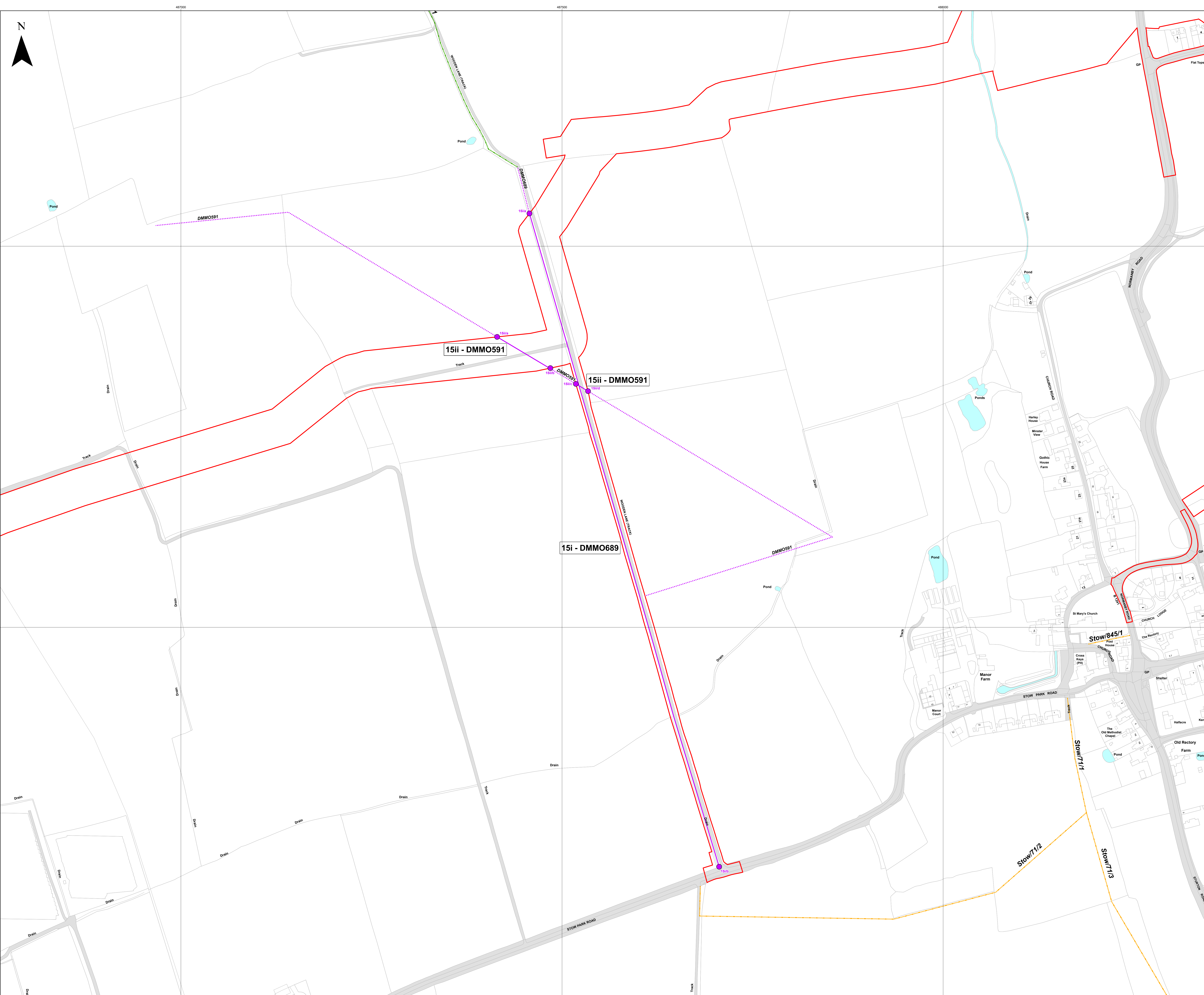

- Key**
- Order Limits
  - Sheet Index
  - DMMO route
  - DMMO route to be temporarily stopped up
  - DMMO to be temporarily stopped up - start and end points
  - PRoW**
  - Bridleway
  - Footpath

**Note:**  
The Definitive Map Modification Order (DMMO) routes shown on the plan are not public rights of way but indicate routes where DMMO applications have been made for these routes to be recorded as public rights of way.  
The temporary stopping up of the DMMO route is subject to approval and will only be considered once accepted within the rights of way definitive map.

Layers: Lincolnshire County Council, 2024; Nottinghamshire County Council, 2024; North Lincolnshire County Council, 2024; Lanpro, 2024; IGP, 2024  
Base map: reproduced from Ordnance Survey digital map data © Crown copyright 2024. All rights reserved. License number 010001673

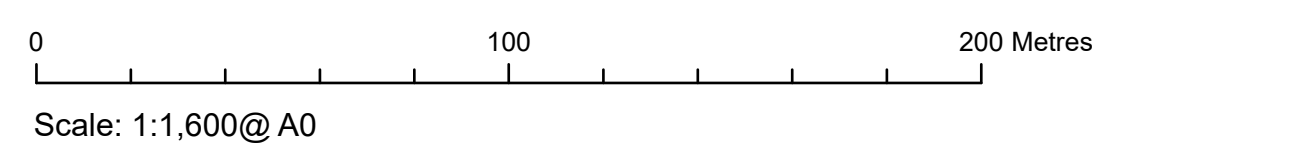







|                                |                            |
|--------------------------------|----------------------------|
| APFP Regulation: 5(2)(k)       | Application Doc No. C2.5_E |
| Ref: P2961_LPR_ZZ_ON_DR_Z_0089 | Date: 27/02/2024           |
| Drawn by: AZ                   | Checked by: BR             |

**Public Rights of Way Plan**  
Sheet: 15 of 20  
Revision E

**COTTAM SOLAR PROJECT**

**Key**

-  Order Limits
-  Sheet Index
-  Potential PRow Diversion Area
- PRow**
-  Footpath
- PRow to be temporarily stopped up**
-  Footpath
- PRow to be temporarily stopped up - start and end points**
-  Footpath

Note:  
The Definitive Map Modification Order (DMMO) routes shown on the plan are not public rights of way but indicate routes where DMMO applications have been made for these routes to be recorded as public rights of way.  
The temporary stopping up of the DMMO route is subject to approval and will only be considered once accepted within the rights of way definitive map.

Layers: Lincolnshire County Council, 2024; Nottinghamshire County Council, 2024; North Lincolnshire County Council, 2024; Lanpro, 2024; IGP, 2024  
Base map: Reproduced from Ordnance Survey digital map data © Crown copyright 2024. All rights reserved. License number 0100031673

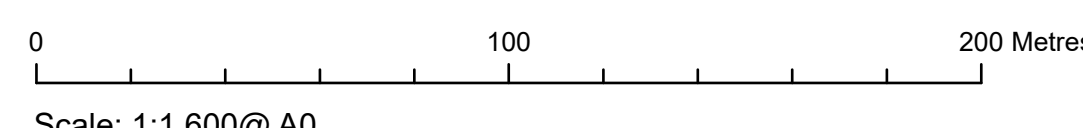

|                                |                            |
|--------------------------------|----------------------------|
| APFP Regulation: 5(2)(k)       | Application Doc No. C2.5_E |
| Ref: P2961_LPR_ZZ_ON_DR_Z_0089 | Date: 27/02/2024           |
| Drawn by: AZ                   | Checked by: BR             |

**Public Rights of Way Plan**  
Sheet 16 of 20  
Revision E

**COTTAM SOLAR PROJECT**

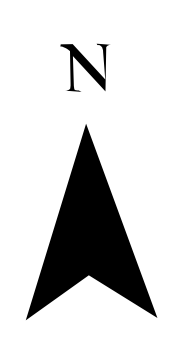
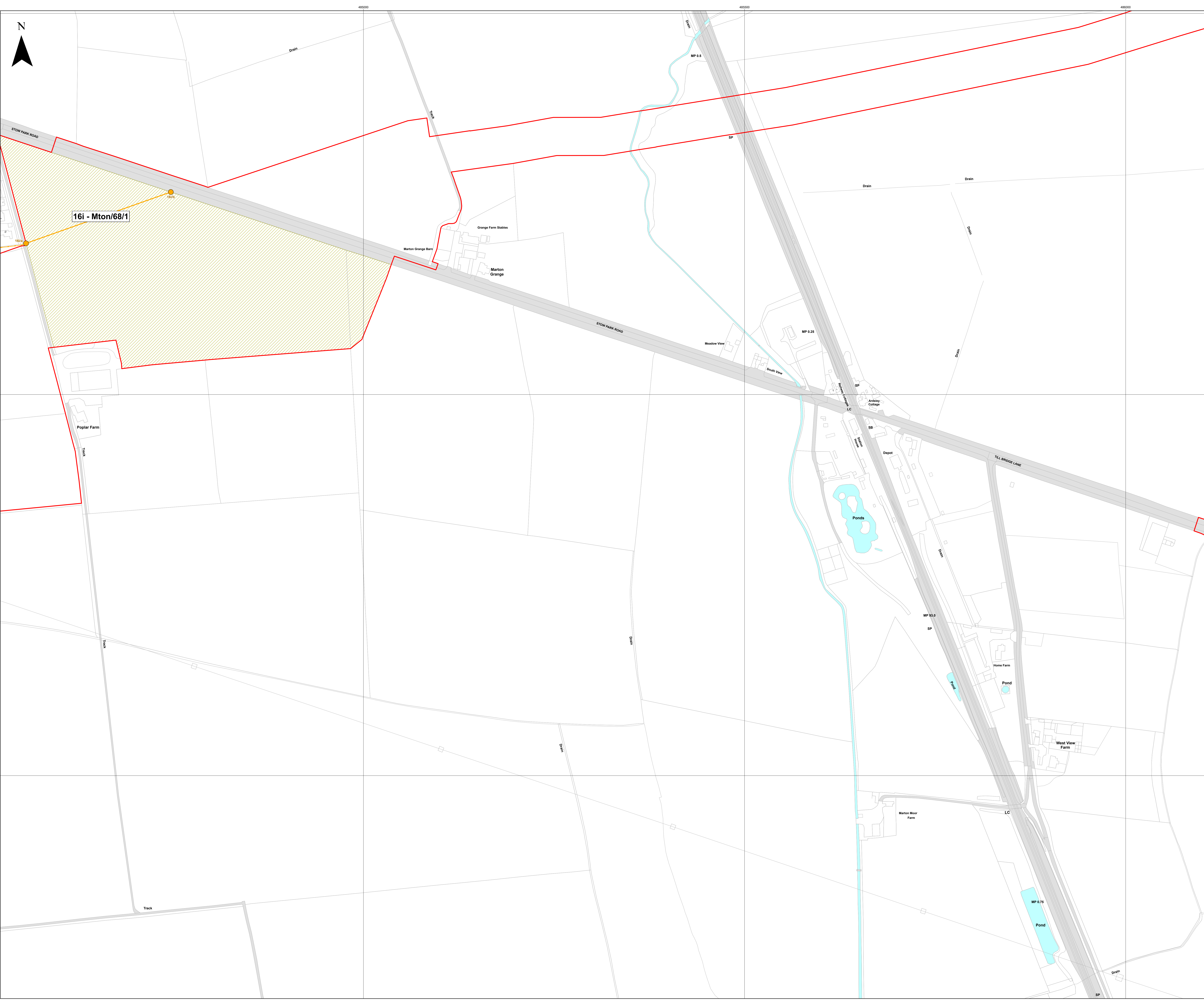

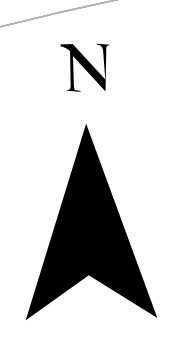
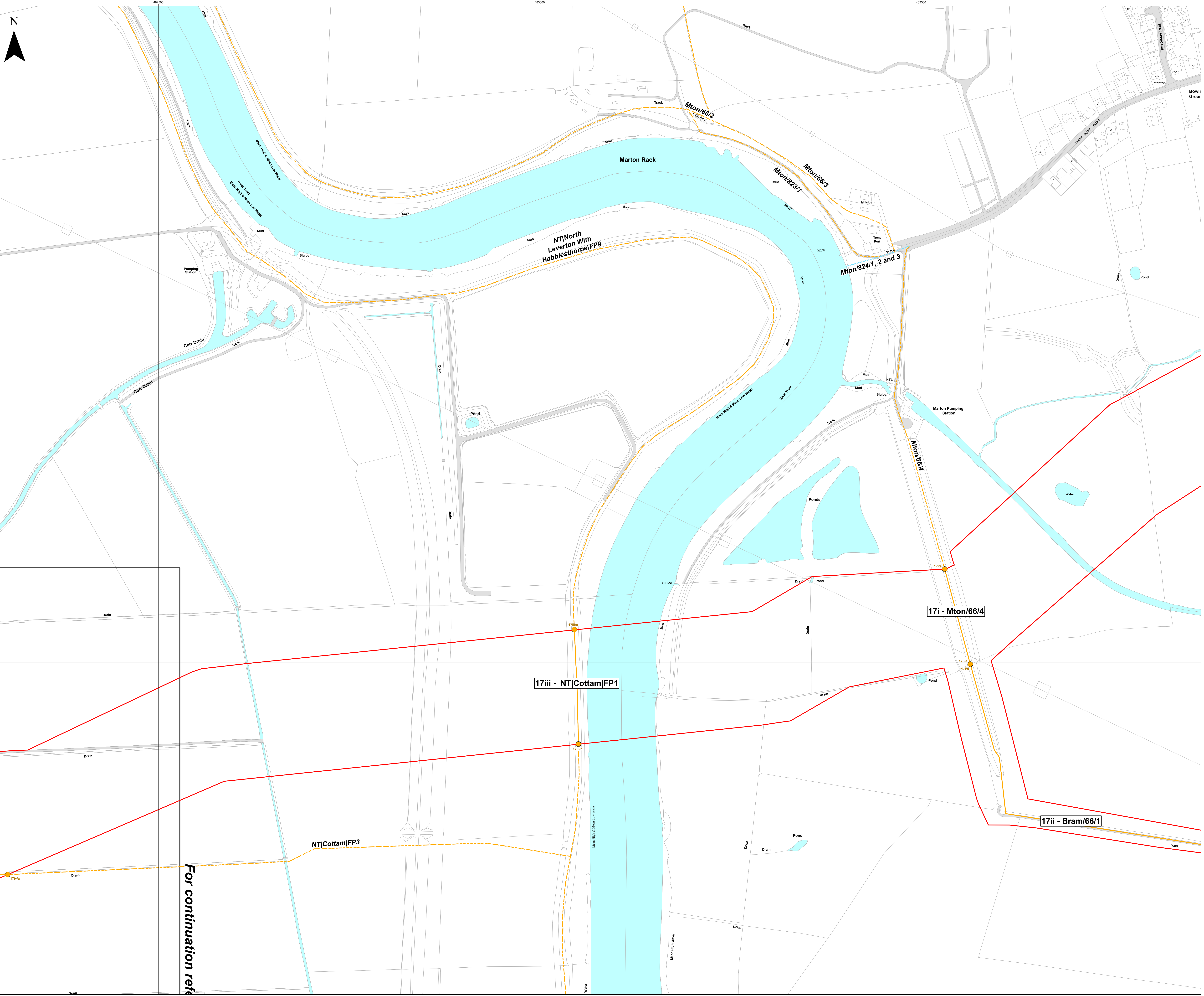

**Key**

- Order Limits
- Sheet Index
- PRoW
- Footpath
- Byway Open to All Traffic
- PRoW to be temporarily stopped up
- Footpath
- PRoW to be temporarily stopped up - start and end points
- Footpath

Note:  
The Definitive Map Modification Order (DMMO) routes shown on the plan are not public rights of way but indicate routes where DMMO applications have been made for these routes to be recorded as public rights of way.  
The temporary stopping up of the DMMO route is subject to approval and will only be considered once accepted within the rights of way definitive map.

Layers: Lincolnshire County Council, 2024; Nottinghamshire County Council, 2024; North Lincolnshire County Council, 2024; Lanpro, 2024; IGP, 2024  
Base map: Reproduced from Ordnance Survey digital map data © Crown copyright 2024. All rights reserved. License number 0100031673

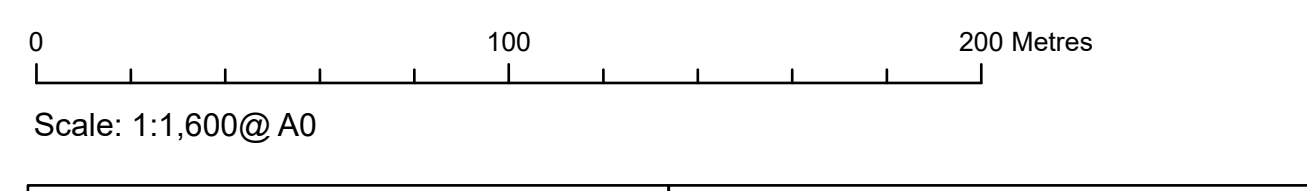

|                                |                            |
|--------------------------------|----------------------------|
| APFP Regulation: 5(2)(k)       | Application Doc No. C2.5_E |
| Ref: P2961_LPR_ZZ_ON_DR_Z_0089 | Date: 27/02/2024           |
| Drawn by: AZ                   | Checked by: BR             |

**Public Rights of Way Plan**  
Sheet 17 of 20  
Revision E

**COTTAM SOLAR PROJECT**

For continuation refer

- Key**
- Order Limits
  - Sheet Index
  - PROW to be temporarily stopped up
  - Footpath
  - Restricted Byway
  - Byway Open to All Traffic
  - PROW to be temporarily stopped up - start and end points
  - Footpath
  - Restricted Byway
  - Byway Open to All Traffic

Note: The Definitive Map Modification Order (DMMO) routes shown on the plan are not public rights of way but indicate routes where DMMO applications have been made for these routes to be recorded as public rights of way.  
The temporary stopping up of the DMMO route is subject to approval and will only be considered once accepted within the rights of way definitive map.

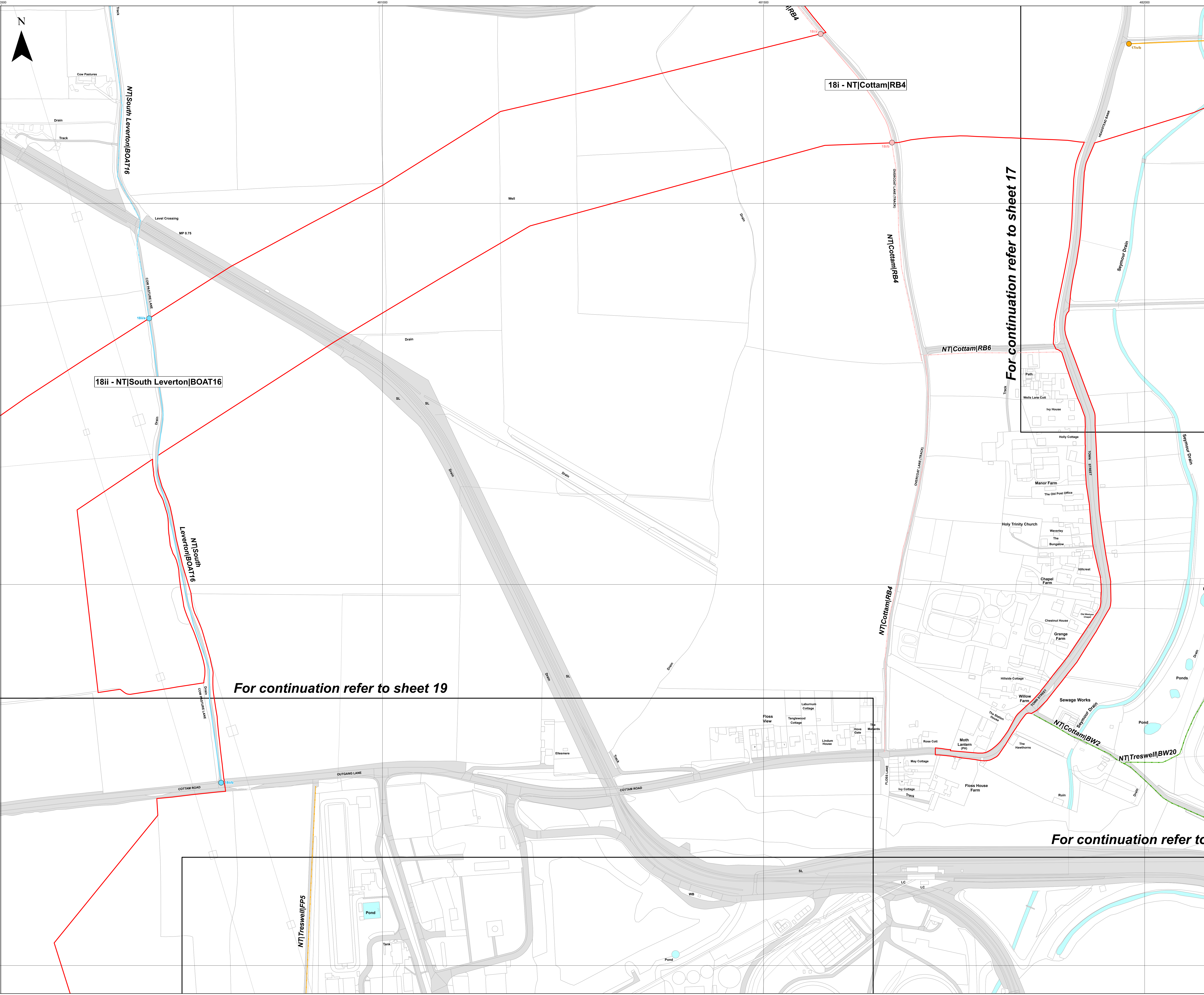

**For continuation refer to sheet 17**

**For continuation refer to sheet 19**

**For continuation refer to**

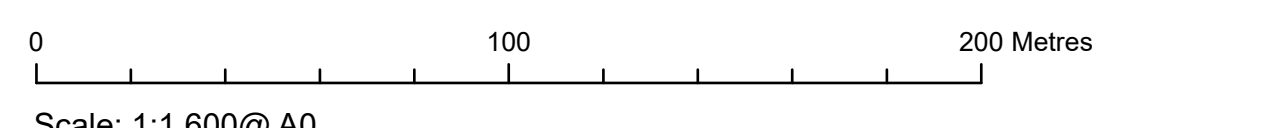

|                                |                            |
|--------------------------------|----------------------------|
| APFP Regulation: 5(2)(k)       | Application Doc No. C2.5_E |
| Ref: P2961_LPR_ZZ_ON_DR_Z_0089 | Date: 27/02/2024           |
| Drawn by: AZ                   | Checked by: BR             |

**Public Rights of Way Plan**  
Sheet 18 of 20  
Revision E

---

**COTTAM SOLAR PROJECT**

Layers: Lincolnshire County Council, 2024; Nottinghamshire County Council, 2024; North Lincolnshire County Council, 2024; Lanpro, 2024; IGP, 2024  
Base map: reproduced from Ordnance Survey digital map data © Crown copyright 2024. All rights reserved. License number 0100031673

**Key**

- Order Limits
- Sheet Index
- Potential PRow Diversion Area
- PRow to be temporarily stopped up
- Footpath
- Byway Open to All Traffic
- PRow to be temporarily stopped up - start and end points
- Footpath
- Byway Open to All Traffic

Note:  
The Definitive Map Modification Order (DMMO) routes shown on the plan are not public rights of way but indicate routes where DMMO applications have been made for these routes to be recorded as public rights of way.  
The temporary stopping up of the DMMO route is subject to approval and will only be considered once accepted within the rights of way definitive map.

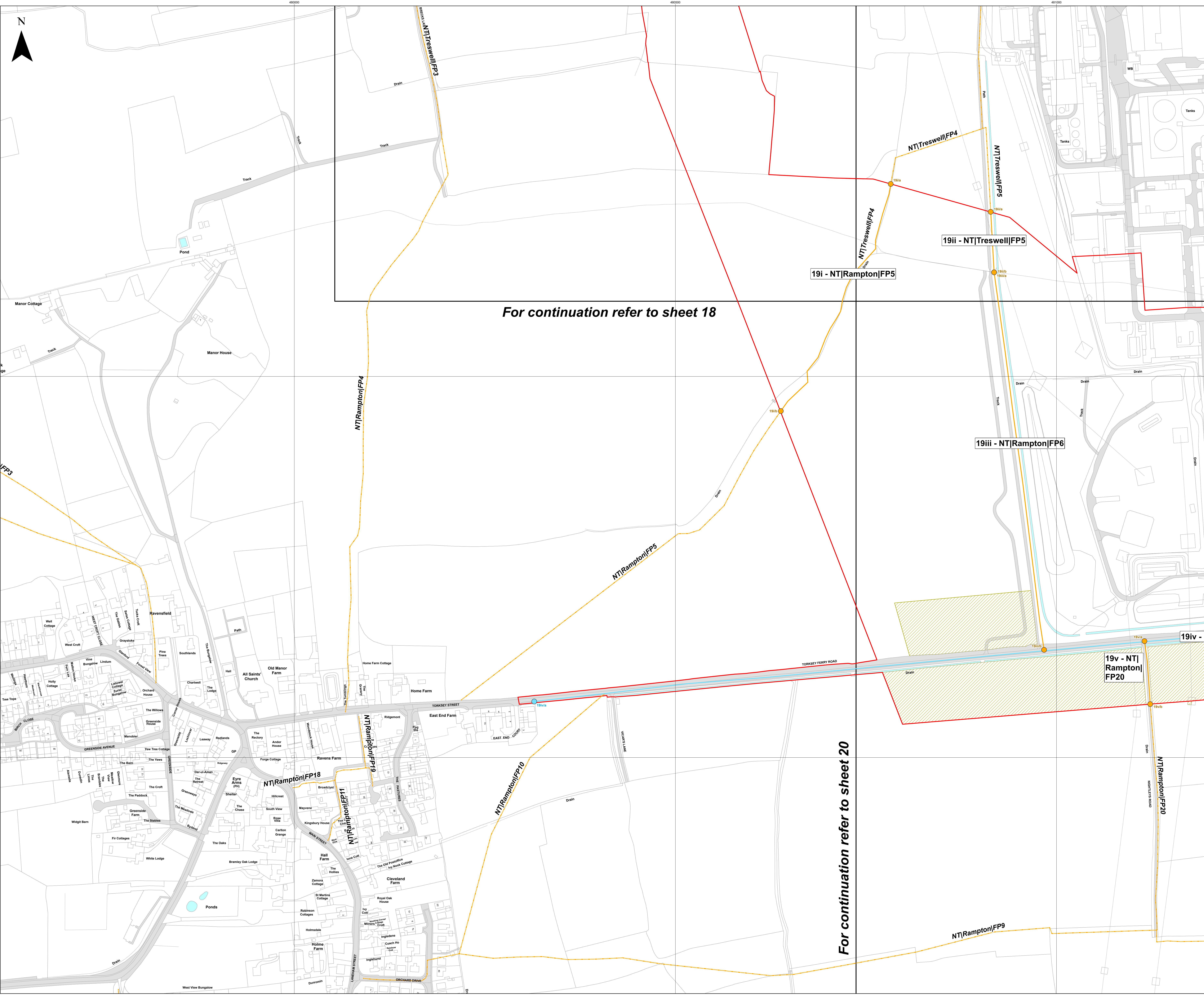









Layers: Lincolnshire County Council, 2024; Nottinghamshire County Council, 2024; North Lincolnshire County Council, 2024; Lanpro, 2024; IGP, 2024  
Base map: reproduced from Ordnance Survey digital map data © Crown copyright 2024. All rights reserved. License number 0100031673

|                                |                            |
|--------------------------------|----------------------------|
| APFP Regulation: 5(2)(k)       | Application Doc No. C2.5_E |
| Ref: P2961_LPR_ZZ_ON_DR_Z_0089 | Date: 27/02/2024           |
| Drawn by: AZ                   | Checked by: BR             |

**Public Rights of Way Plan**  
Sheet 19 of 20  
Revision E

**COTTAM SOLAR PROJECT**

**Key**

-  Order Limits
-  Sheet Index
-  Potential PRoW Diversion Area
- PRoW**
-  Footpath
-  PRoW to be temporarily stopped up
-  Byway Open to All Traffic
-  PRoW to be temporarily stopped up - start and end points
-  Byway Open to All Traffic

**Note:** The Definitive Map Modification Order (DMMO) routes shown on the plan are not public rights of way but indicate routes where DMMO applications have been made for these routes to be recorded as public rights of way.

The temporary stopping up of the DMMO route is subject to approval and will only be considered once accepted within the rights of way definitive map.

Layers: Lincolnshire County Council, 2024; Nottinghamshire County Council, 2024; North Lincolnshire County Council, 2024; Lanpro, 2024; IGP, 2024  
Base map: Reproduced from Ordnance Survey digital map data © Crown copyright 2024. All rights reserved. License number 0100031673

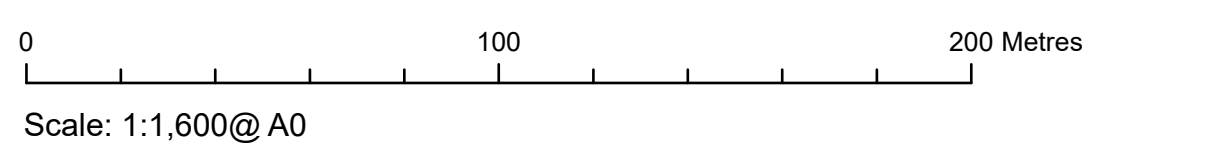

|                                |                            |
|--------------------------------|----------------------------|
| APFP Regulation: 5(2)(k)       | Application Doc No. C2.5_E |
| Ref: P2961_LPR_ZZ_ON_DR_Z_0089 | Date: 27/02/2024           |
| Drawn by: AZ                   | Checked by: BR             |

**Public Rights of Way Plan**  
Sheet 20 of 20  
Revision E

---

**COTTAM SOLAR PROJECT**

